

SLA

FACTORY ACTIVATED

SLA | READY TO START

REF **BB5L-B**



12V VOLTAGE - V

65A CCA - A

5.3Ah CAPACITY - Ah (20Hr)

5Ah CAPACITY - Ah (10Hr)

TECHNOLOGY

- Designed according to AGM technology (Absorbed acid)
- VRLA battery type
- Activated and pre-charged batteries
- Homologated by OEM

FEATURES

- AGM construction (Absorbed Glass Material)
- VRLA battery (Valve Regulated Lead Acid)
- Factory activated
- Environmentally friendly, spillproof design
- Multi-positional fitment
- Absolutely Maintenance free
- Sealed, no gas emission through venting hole (under normal operation)
- Ready & Easy to use
- No acid handling - Very safe
- Increased power & Extended life
- Extreme vibration resistance

UPGRADE FOR

12N5-3B

WEIGHT

Battery (with acid) : Approx 2.00kg (4.41 lbs)

MOUNTING ANGLE

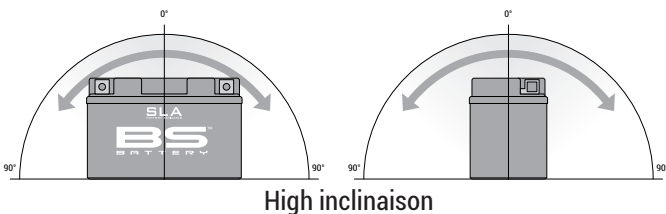

DIMENSIONS

Length (A) : 120±2mm (4.72 in)
 Width (B) : 60±2mm (2.36 in)
 Container height : 130±2mm (5.12 in)
 Total height (C) : 130±2mm (5.12 in)

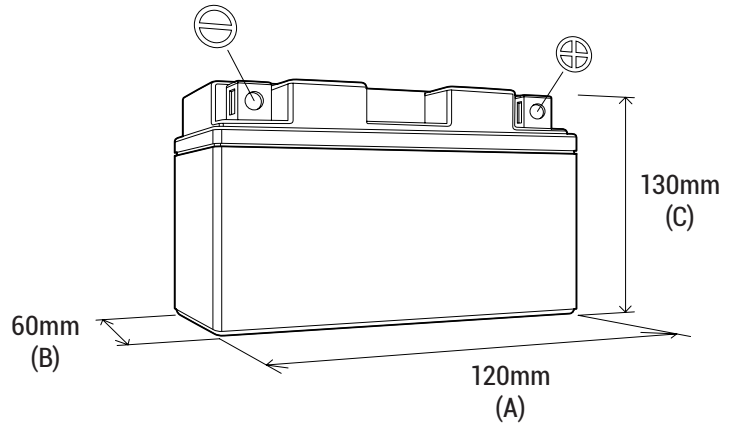

TERMINALS

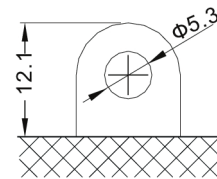

FRONT

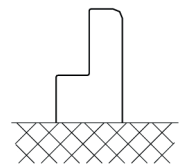

SIDE

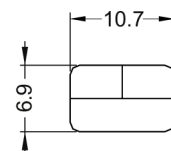

TOP